

# Electric Fireplace

Model Number: EF-800020

## OWNER'S MANUAL



### WARNING

Read and understand this entire owner's manual, including all safety information, before plugging in or using this product. Failure to do so could result in fire, electric shock, or serious personal injury.



### CAUTION

Keep this owner's manual for future reference. If you sell or give this product away, make sure this manual accompanies this product.

## IMPORTANT SAFETY INSTRUCTION

- Read all instructions before using this heater.
- This heater is hot when in use. To avoid burns, DO NOT let bare skin touch hot surfaces. If provided, use handles when moving this heater. Keep combustible materials, such as furniture, pillows, bedding, papers, clothes, and curtains at least 3 feet (0.9m) from the front of the heater, and keep them away from the sides and rear.
- Extreme caution is necessary when any heater is used by or near children or invalids and whenever the heater is left operating and unattended.
- DO NOT operate any heater with a damaged cord or plug or after the heater malfunctions, has been dropped or damaged in any manner. Discard heater, or return to authorized service facility for examination and/or repair.
- DO NOT run power cord under carpeting. DO NOT cover power cord with throw rugs, runners, or similar coverings. DO NOT route power cord under furniture or appliances. Arrange power cord away from traffic area, and where it will not be tripped over.
- DO NOT insert or allow foreign objects to enter any ventilation or exhaust opening, as this may cause electric shock or fire, or damage the heater.
- To prevent a possible fire, DO NOT block air intakes or exhaust in any manner. Doing so could cause a fire. DO NOT use on soft surfaces, like a bed, where openings may become blocked.
- A heater has hot and arcing or sparking parts inside. DO NOT use it in areas where gasoline, paint, or flammable liquids are used or stored.
- Use this heater only as described in this manual. Any other use not recommended by the manufacturer may cause fire, electric shock, or injury to persons.
- ALWAYS plug heaters directly into a wall outlet/ receptacle. NEVER use with an extension cord or relocatable power tap (outlet/ power strip).
- Connect to properly grounded outlets ONLY.
- DO NOT place the heater near a bed because objects such as pillows or blankets can fall off the bed and be ignited by the heater.
- NEVER use this heater in bathrooms, laundry rooms, or any other location where the heater could fall into a bathtub or pool, become damp, or come in contact with water.
- Regularly inspect all air vents to make sure they are free from dust, lint, or other blockage. Unplug the unit and clean with a vacuum ONLY. DO NOT rinse or get wet.

WARNING: DO NOT DEPEND ON THE POWER SWITCH THE SOLE MEANS OF DISCONNECTING POWER WHEN SERVICING OR MOVING THE HEATER. ALWAYS UNPLUG THE POWER CORD.

WARNING: REDUCE THE RISK OF FIRE OR ELECTRIC SHOCK --- DO NOT USE THIS HEATER WITH ANY SOLIDSTATE SPEED CONTROL DEVICES.

- For residential use only! NOT for commercial use! Any commercial or public use of this heater voids all warranties, and could cause injury.
  - This product is not intended to be a primary heat source. It is for supplemental heat only.
  - INDOOR use only! NEVER use this heater outdoors! Doing so may result in electric shock!
  - Risk of electric shock! DO NOT OPEN! No user-serviceable parts inside!
  - NEVER modify this heater. Doing so could result in personal injury or property damage. Modification of this fireplace completely voids all warranties.
  - ALWAYS turn this heater off before unplugging it from the outlet.
  - ALWAYS disconnect this unit from the power supply before performing any assembly or cleaning, or before relocating the electric fireplace.
  - NEVER leave this heater unattended. ALWAYS unplug this heater when not in use.
  - ALWAYS store this heater in a dry location. NEVER use the fireplace if it has become wet.
  - ONLY use this heater on a 220-240V AC circuit. NEVER overload the circuit. If this heater trips the circuit breaker, unplug all other appliances on the same circuit before the next use. Avoid plugging other appliances into the same circuit as this heater.
  - NEVER plug this heater into an outlet that is old, cracked, or has any loose wires or connections. Plugging this heater into a faulty outlet could result in electric arcing within the outlet that could cause the outlet to overheat or catch fire.
  - ALWAYS check your heater cord and plug connections with each use!
1. MAKE SURE the plug fits right in the outlet! Faulty wall outlet connections or loose plugs can cause the outlet to overheat.
  2. Heaters draw more current than small appliances. Overheating may occur even if it has not occurred with the use of other appliances.
  3. During use check frequently to see if the plug outlet or face plate is HOT!
  4. If the outlet or face plate is HOT, discontinue use immediately and have a qualified electrician inspect and/or replace the faulty outlets.

-This heater has a VDE plug. As a safety feature to reduce the risk of electrical shock, this plug is intended to fit in a VDE outlet only one way. If the plug does not fit fully in the outlet, reverse the plug. If it still does not fit, contact a qualified electrician. Do not attempt to defeat this safety feature.

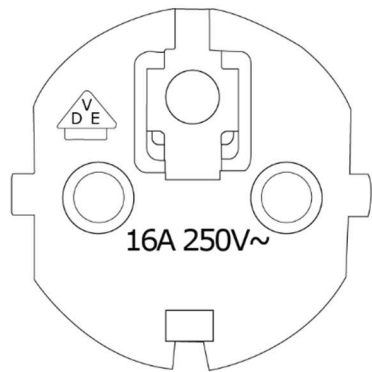

**TECHNICAL SPECIFICATION**

Description	Recessed or Wall-mount Appliance
Voltage	230V AC
Watts	Max 2000W
BTUs	5100BTU
Size	800*126*350mm

**PACKING LIST**

No	Description	Quantity
1	Firebox	1 pcs
2	Manual	1 pcs
3	Remote Control(Battery not include)	1 pcs
4	Anchor Screws(4*30mm)	7 pcs
5	Metal Screws(4*6mm)	2 pcs
6	Wall anchors(8*35mm)	7 pcs
7	Crystal Stone(bag)	1 pcs
8	T-Shaped brackets	1 pcs



## INSTALLATION AND ASSEMBLY

### RECESSED OPTION:

Step 1. Remove the Glass Panel and Screws.

Remove white screws on both side from the appliance first.

And remove white screws on both corner from the glass panel, carefully lift upward the front glass panel to take it down.

NOTE: Please keep the screws safe.

They are not extra accessories.

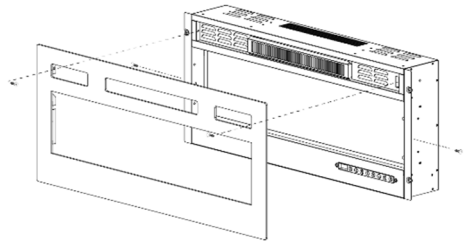

Step 2. Put the fireplace into the hole of wall

Find a safe location. Minimum clearance from the ceiling to the top of the fire must be at least 200mm; minimum clearance from the floor to the bottom of the fire must be at least 200mm; minimum clearance from the front must be at least 900mm.

Choosing a location near an outlet so an extension cord is not required.

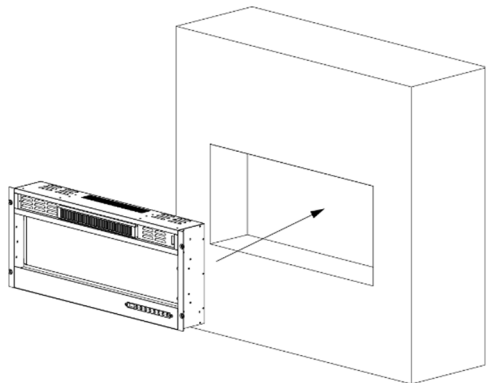

**Step 3. Secure the fireplace**  
Mark the left and right anchor  
screws secure positions on the  
wall in accordance with the  
fireplace s holes.

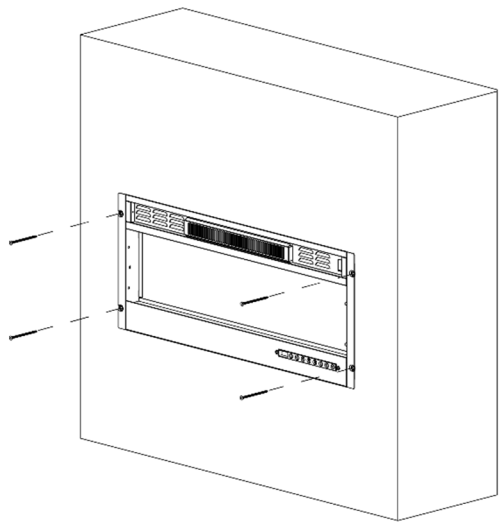

**Step 4. Placing the Decorations**  
Carefully pour crystal stone evenly  
distribute the supplied into the  
fireplace bottom tray.

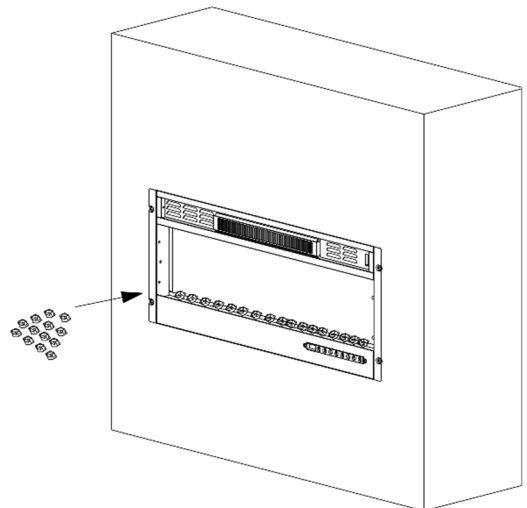

### Step 5. Reinstall the glass panel

Place the front glass panel over the front of the fireplace aligning the slots at each side of the glass panel with the lugs on the sides of the fire.

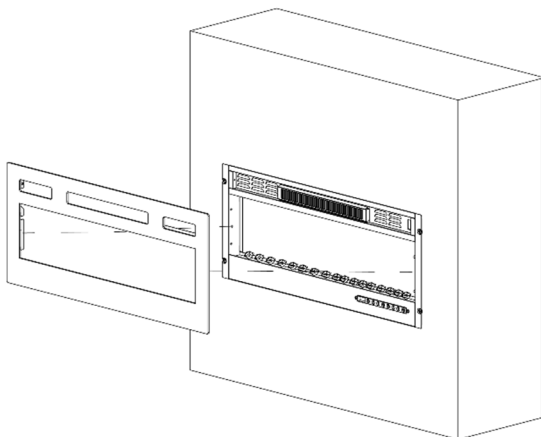

### Step 6. Reinstall the screws.

Locate the screws that were removed in **Step 1** and reinstall them into the holes in the glass panel. The installation is completed now.

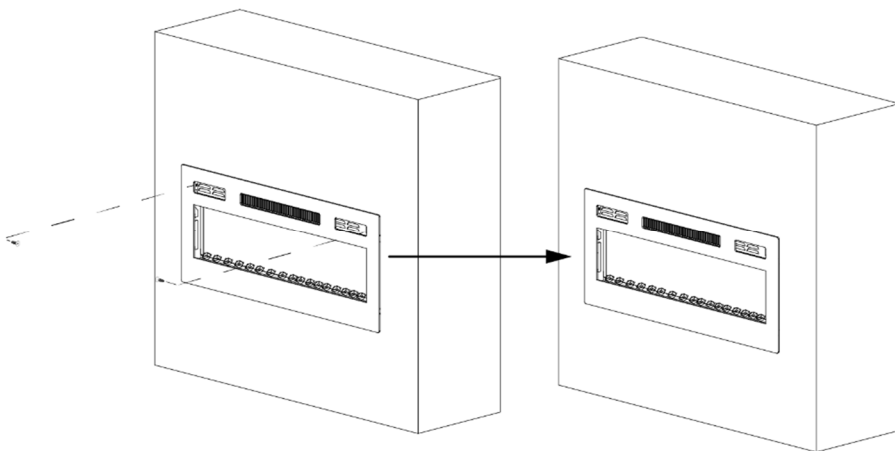

## WALL MOUNT OPTION:

Step 1. Remove the Glass Panel and Screws.

Remove **WHITE** screws on both side from the appliance first.

And remove screws on both corner from the glass panel, carefully lift upward the front glass panel to take it down.

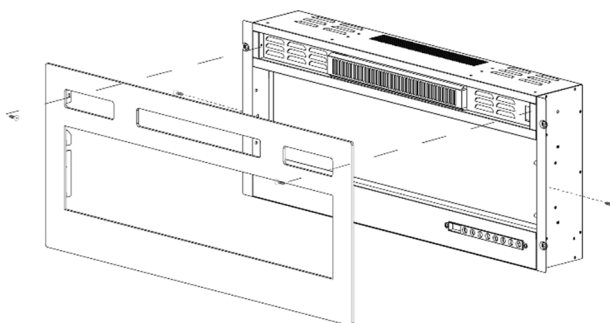

Step 2. Determine the distance in the wall and drill holes

Find a safe location. Determine the distance in the wall and drill holes (A= 683mm), and hammer wall anchors (8"35mm) and anchor screw (4"30mm) into the holes in the wall.

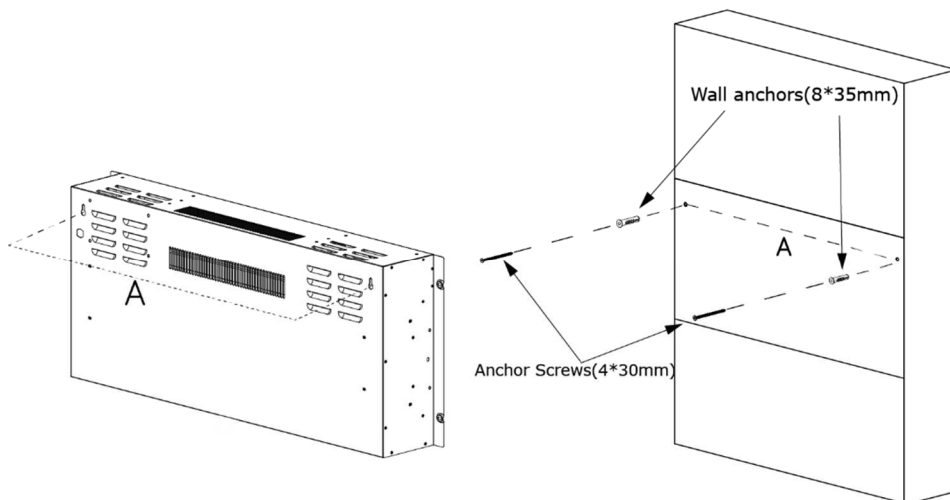



### Step 3. Hang the fireplace on the wall and lock the T-shaped bracket

Locate the back hanging hole shown in **Step 2** and align it with the completed hole in the image above and hang it on the screw.

Fix the T-shaped bracket in the middle of the bottom with the two screws (4"6mm) supplied.

Mark the location on the wall in according with the third hole of the T-shaped bracket.

Drill a hole and hammer the wall anchors (8"35mm), then screw and fix it with screw (4"30mm).

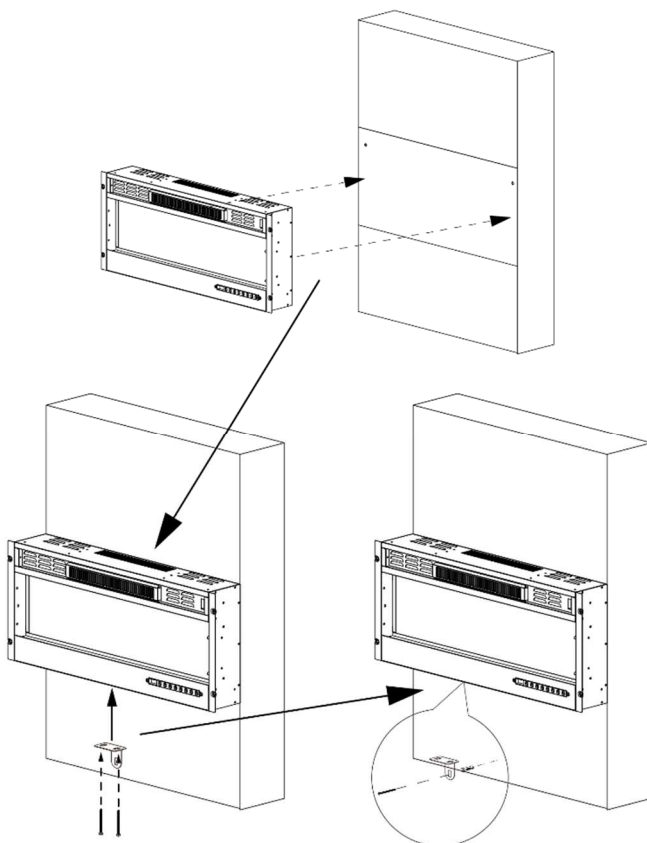

#### Step 4. Placing the Decorations

Carefully pour crystal stone evenly distribute the supplied into the fireplace bottom tray.

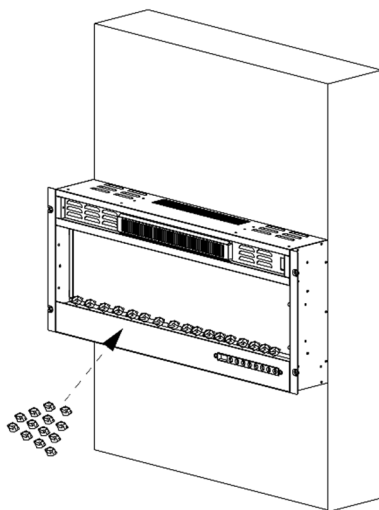

#### Step 5. Reinstall the glass panel and reinstall the screws.

Place the front glass panel over the front of the fireplace aligning the slots at each side of the glass panel with the lugs on the sides of the fire.

Locate the screws that were removed in **Step 1** and reinstall them into the holes in the glass panel.

The installation is completed now.

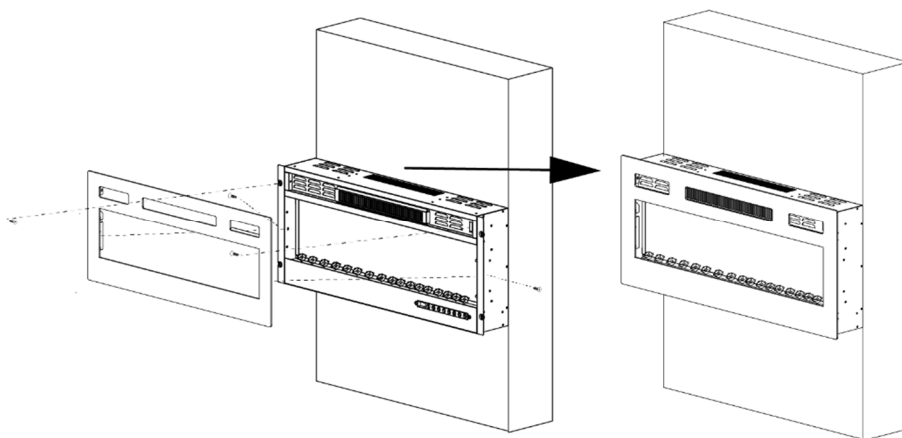

## OPERATION





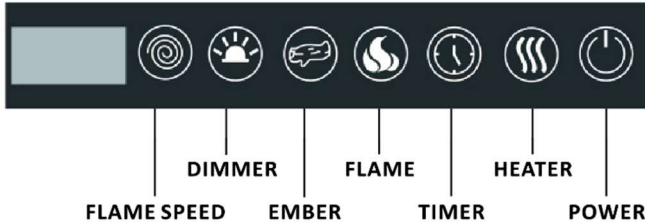

### MAIN POWER SWITCH

The Main Power Switch is located on the upper right of the fireplace as illustrated, it must be turned ON before using.

### CONTROL PANEL



The touch display panel is shown on the down right of the front of the appliance.

POWER		Turn the appliance ON/OFF. NOTE: Make sure the main switch on the upper right of fireplace is turned on before operating.
DIMMER		Control Flame Brightness. 5 Settings: (P1-P2-P3-P4-P5) Flame dims from P1 to P5. P5 is the brightest setting.
TIMER		Control The Timer. 9 Settings: (1H,2H,3H,4H,5H,6H,7H,8H,9H) Press button until reach desired setting.
FLAME SPEED		Control Flame Speed. 5 Settings: (L1-L2-L3-L4-L5) Flame speed from L1-L5. L5 is the fastest setting.
HEATER		Control the Heater Press button to initiate the heater. (--) no heater or blower, (-1), heater blows warm air(1000W), (-2), heater blows warm air(2000W)
FLAME		Control the flame color. 8 settings: 01.orange 02.red&orange 03.red 04.red&blue 05.red&blue&orange 06.blue 07.blue&green 08.Auto 00.Off.
EMBER		Control the flame ember color. 8 settings: 01.orange 02.red&orange 03.red 04.red&blue 05.red&blue&orange 06.blue 07.blue&green 08.Auto 00.Off.

**NOTICE:** To improve operation, aim the remote control at touch panel of the fireplace. DO NOT press the buttons too quickly. Give the unit time to respond to each command.

## REMOTE CONTROL OPERATION

**NOTICE:** There are a total of FOUR heating modes, including Heating, Auto Heating, Hourly Timing Heat, Weekly Timing Heat, each time only ONE mode can be chosen.

**NOTICE:** Weekly timing function and window open function can be only operated through remote control.

**NOTICE:** The remote control is a priority. If the remote setting is different from the touch panel setting, the appliance will perform the remote setting.

**NOTICE:** The remote control displays the room temperature when it is not being operated.



### Heating Mode

-Press the "HEAT" button on the remote control,the first press selects the 1000W heat setting, the second press selects the 2000W heat setting, the third press turn the heat off, so it cycles.

### Auto Heating Mode

-Press the "AUTO" button on the remote control to activate the temperature setting.

-Press the "+" button on the remote control to increase the desired temperature.

-Press the "-" button to decrease the desired temperature. The temperature can be set between 18-35°C.

-Press the "HEAT" button, the Auto Heating Mode will be activated and automatically heat or stop according to the temperature setting.

## Hourly Timing Heat

- Press and hold the "TIME ON/OFF" button for 5 seconds, "1h" timer will be show on the remote display, and short pressing the "TIME ON/OFF" button again, 1h-9hour timer will display in sequence.
- After 3 seconds, the Hourly Timing Heat Mode will be activated automatically.
- Press the "TIME ON/OFF" button for 5 seconds again, exit the Hourly Timing Heat Mode, or short pressing till 9hour, one more press, exit the Hourly Timing Heat Mode too.

## Weekly Timing Heat

### STEP 1: Setting the Current Day and Time

- Press the "DATE TIME" button on the remote control, the day of the week will flash. Use the ↑ and ↓ buttons to set the day of the week. Once the current day is set, press the "DATE TIME" button to confirm the current day.
- The hour setting will then flash once the day has been selected. Use "+" or "-" to adjust the time until the current hour is selected. Press the "DATE TIME" button to confirm the current hour.
- Then the minute setting will flash once the hour has been set. Use "+" or "-" to adjust the time until the current minute is set correctly. Press the "DATE TIME" button to confirm the current minute.

### STEP 2: Setting the Heat Timer

- Press the "TIMER SET" button on the remote control, the timer cycle number will flash.
- Use the "+" and "-" buttons to cycle through the different timer cycles from 1 to 10 and press the "TIMER SET" button to confirm. A small black triangle will flash below one day of the week, indicating that the day of the week need to be determined.
- Press the "CLEAR" button can cancel the set time conveniently.

### STEP 3: Selecting the Day

- Press the ↑ or ↓ buttons on the remote control to choose the set day between "SUN" to "SAT", the default day is "SUN". **PRESS THE "+" BUTTON TO CONFIRM THE SET DAY**, then press the "TIMER SET" button to confirm.
- Repeat **STEP 1** to add other days to the chosen timer cycle, or press the "-" button to delete the set day. Press the "TIMER SET" button to confirm.

#### **STEP 4: Set TIMER ON Time**

The "ON" symbol will illuminate on the LCD display to indicate that the Timer ON will need to be set.

- Press the "+" or "-" button to set the hour setting for Timer ON and press the "TIMER SET" button to confirm.
- Press the "+" or "-" button to set the minute setting for Timer ON and press the "TIMER SET" button to confirm. The "ON" symbol will turn off and the "OFF" symbol will illuminate.

#### **STEP 5: Set TIMER OFF Time**

- The "OFF" symbol will illuminate on the digital display to indicate that the Timer OFF will need to be set.
- Press the "+" or "-" button to set the hour setting for Timer OFF and press the "TIMER SET" button to confirm.
- Press the "+" or "-" button to set the minute setting for Timer OFF and press the "TIMER SET" button to confirm.

#### **STEP 6: Setting Desired Temperature**

- Once the Timer ON and OFF times have been set, the desired temperature will begin to flash on the digital display.
- Press the "+" or "-" button to set the desired temperature between 18-35°C, **PRESS "TIMER SET" BUTTON TO CONFIRM;**
- Repeat the above procedure to set more timer cycles if required.

#### **STEP 7: Press "HEAT", then press "TIMER ON/OFF" button to activate the Weekly Timer Heat function**

- Anytime you can press "TIMER ON/OFF" button again to exit the Weekly Timer Heat Mode.

#### **Window Monitor Mode**

- When this function is enabled, if the ambient temperature is lowered due to the opening of the doors or windows, indicator light on "HEAT" button on the appliance will blink to remind the user to close the windows or doors.
- If there is no response, the system will automatically stop heating. Press the window button once to active the window monitor.
- Press it again to switch the window monitor off.

#### **Flame Color Selection**

- Press "FLAME" button to choose the flame color you like, touch screen digital

display 01-07, representing 7 different colors, 08 is the automatic transformation of 7 colors.

### **Flame Ember Color Selection**

-Press "EMBER/AMBIENT" button to choose the flame ember color you like, touch screen digital display 01-07, representing 7 different colors, 08 is the automatic transformation of 7 colors.

### **Flame Brightness Selection**

-After flame or ember chosen, press "+" or "-" button to adjust the brightness of flame, P1-P2-P3-P4-P5, P5 is the brightest setting.

### **Flame Speed Selection**

-Press" ↑ "or" ↓ "button to adjust the speed of flame, L1-L2-L3-L4-L5,L5is the fastest setting.

## **CARE AND MAINTENANCE**

### **TROUBLE SHOOTING**

Safety Cut-Out device:

To ensure against the potential hazard caused by blockage of the air outlet, this unit is equipped with an automatic over-temperature safety cut-out device. When the device is activated, the heater will not operate. If this occurs, the unit can be reset using the following procedure.

-Turn the fire off by depressing the on/off switch on the unit.

-Unplug the power cord from the electrical mains supply socket and leave it disconnected for at least 15 minutes.

-Ensure that the air vents are free from obstruction.

Plug the power cord back in to the mains socket.

-Turn the fire back on.

-If the fire fails to operate, check the fuse in the plug (just suitable for BS plug).

-If the fuse in the plug is OK and the fire is still not functioning, contact a qualified service person.

<b>Problem</b>	<b>Potential cause</b>	<b>Corrective action</b>
The fire won't turn on	Mains plug is not plugged in. The On/Off switch hasn't been switched on.	Check the mains socket to ensure the plug has been inserted correctly. Switch on using the operation switches. Check and change the fuse in the plug.

	The fuse in the plug has brown.	
No heat.	The "POWER" and the "HEAT" switches are not turned on. Auto Heat or Timer Heat be activated, it standby	Turn these two switches on. Check Heat Mode selection.
Heater operates and then the heat cuts out.	The safety cut-out may have operated.	Follow the procedure as outlined in the "safety cut-out device" section.
The remote control does not work.	The battery is not properly installed. Not pointing to the right position. Press the remote control buttons too quickly.	Make sure the battery is properly installed. Move the battery's transparent insulating piece away before using. Aim the remote control at the receiver. Don't press the remote control buttons too quickly. Give the unit time to respond to your commands.

## CLEANING AND CARE

- Unplug the appliance and allow the unit to cool down completely before cleaning.
- There are no specific requirements for the care of this unit, other than general cleaning.
- If the supply cord is damaged, it must be replaced by a suitably qualified person.
- The area around the fire should be kept free from animal hair, lint and other extraneous material that may be drawn into the workings of the appliance which could affect its performance.

